

General safety warning signs and instructions



General warnings, please observe the following instructions!

WARNING



Warning, crushing hazard!



Warning, sharp object!



Warning of hot surfaces!



Warning of flammable substances / fire hazard warning



Read the operating instructions for your device and the enclosed safety instructions carefully!



Always disconnect your device from the power source before carrying out repair work!



Always wear suitable protective gloves!

Safety instructions

Extractor hood

IMPORTANT

These are only exemplary illustrations, please always refer to the operating instructions for your device!

All safety instructions describe in detail the potential risks they address and contain precise instructions on how to avoid injury, damage to property or electric shock as a result of improper handling. Please observe the following guidelines:



WARNING



1. Disconnect the appliance from the power supply before carrying out the procedures described.
2. Use protective gloves before starting work.

- Always disconnect the appliance from the power source before carrying out installation work.
- Installation and repairs should be carried out by qualified specialists in accordance with the manufacturer's instructions and the applicable local safety regulations. Therefore, only carry out repairs or replace parts yourself if this is expressly provided for in the user manual.
- Only use certified spare parts, in case of doubt original spare parts
- Do not touch accessories and spare parts with wet hands
- The appliance should only be connected to the power supply after installation has been completed.
- Children and persons with reduced physical, sensory or mental capabilities or lacking sufficient experience and knowledge should only use the appliance under supervision or after thorough instruction by responsible persons.
- Children must be supervised to ensure that they do not play with the appliance.
- Always wear work gloves for all installation and maintenance work.
- Failure to comply with the cleaning instructions for the extractor hood and for filter maintenance can result in a fire hazard.
- Allow light bulbs to cool down before touching them.
- Do not use the cooker hood without a correctly fitted light bulb, otherwise there is a risk of electric shock.
- Keep packaging materials out of the reach of children: Children could wrap themselves in packaging materials such as plastic bags or foil or pull them over their heads, which can lead to a choking hazard. Therefore, make sure that packaging materials are kept out of the reach of children.

Exemplary removal of metal grease filters

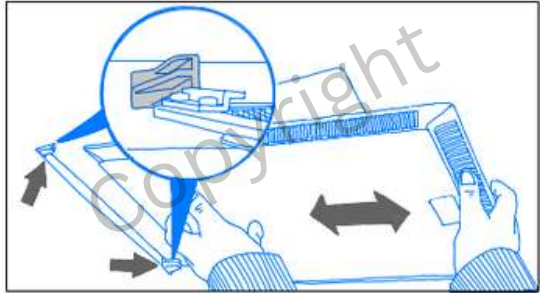
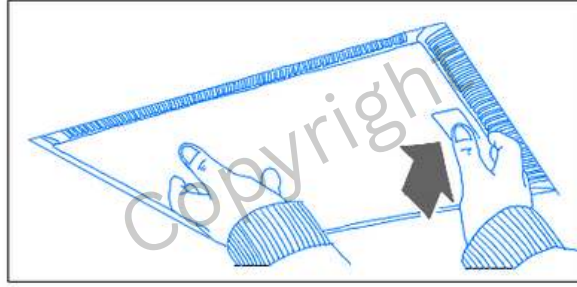
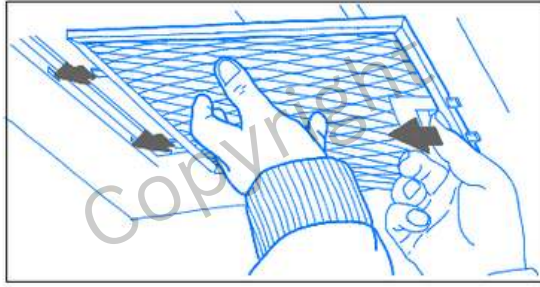

Exemplary removal of activated carbon filters

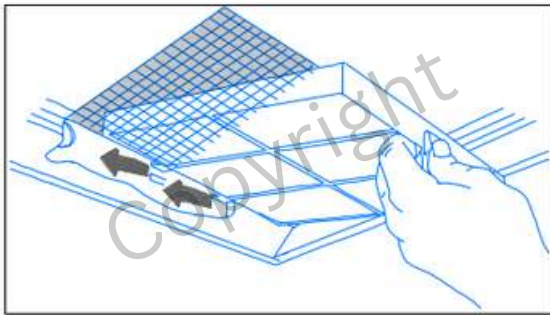

Exemplary removal of halogen/incandescent lamp

